

★★★★★ L
**GRAND HOTEL
SAN PIETRO**
TAORMINA

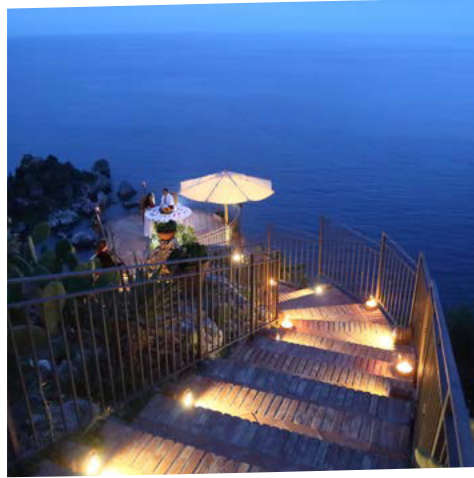

Hotel

A terrace on the Ionian Sea, so close that you can hear the sea roaring and the waves crashing on the quiet coasts of Isola Bella and the imposing Mount Etna which dominates the entire landscape; this is the sight of incomparable beauty that welcomes the guests of the Grand Hotel San Pietro. The hotel, immersed in the fragrances and colours of the luxuriant Sicilian vegetation, is located not far from the centre of Taormina. The Hotel has different types of rooms, all furnished in typical Sicilian style, round-the-clock reception desk, two bars, a restaurant with outdoor terrace, a swimming pool with umbrellas and sunbeds, an indoor gym with Technogym equipment, conference room, beauty corner, private parking.

Wi-fi

Free and available everywhere in the Hotel.

Suite

63 Camere: 20 Classic Suite, 30 Deluxe sea view terrace di cui 4 Family Deluxe sea view terrace, 8 Junior Suite sea view terrace, 4 Junior Suite Vista Giardino Terrazza, 1 Isola Bella Regal Suite.
Check-in: from 14:00. Check-out: before 12:00.

Facilities suite

Double or Twin Beds (3rd extra bed for children/adults, possible in Classic Suite and Junior Suite Garden View Terrace). Flat screen TV, minibar, bathroom with shower, hairdryer, safe, magnifying mirror, bathrobe, slippers, individually regulated air conditioning and heating. Free cot. Television 50-inch TVs with Sky and Dazn.

Restaurant "Il Giardino degli Ulivi"

A la carte gourmet restaurant, with the internal dining room that can accommodate up to 100 people and a panoramic terrace that can accommodate up to 200 people.

Bar

1 lounge bar, 1 pool bar.

Beach

Umbrellas and sun beds are available for a fee and provided by the seaside resort which has an agreement with the Hotel.

Parking

Free private parking for up to 60 cars, unattended but protected by an access bar.

Airport

Catania 67 km (50 min),
Palermo 293 km (3 hours).

Services with extra charge

Car rental, excursions, laundry service, baby sitting. On request, possibility to buy family plus and guest plus packages.

Fitness Room

Indoor gym of 160 sqm equipped Technogym with 1 treadmill, 1 exercise bike Elliptical and 1 byke.

SPA

With 220 square meters of extension, offers two tanks Jacuzzi of 218 x 91h cm each, sauna Finnish, Turkish bath, two emotional showers Artic + Tropic, Himalayan salt walls, area relaxation garden view, two changing rooms and cabins for massages and facial treatments.

Swimming pool

Located in the garden with a splendid view equipped with sunbeds and umbrellas. Length mt. 18,20 - Width mt. 8,60 Minimum depth mt. 1,20 - maximum mt. 2,40



Meeting rooms

MEETING ROOM	MEASUREMENTS				DAY LIGHT	SEA VIEW	OVERHEAD PROJECTOR	FIX SCREEN	STANDARD AUDIO VISUAL	THEATRE	BOARD	CABARET STYLE	CLASS	U SHAPE	CLOSED U SHAPE
	L	W	M2	H											
CAMILLERI	15	5,30	94,50	2,75	x	x	x	x	x	66	40	40	40	30	40
BIBLIOTECA	7	5	35,80	3	x		x	x	x	25	10	18	15	12	
TEA ROOM	4,80	5	23,20	3								8			
ARCADIA	11,80	10	59	3			x	x	x	40	25	30	20	20	

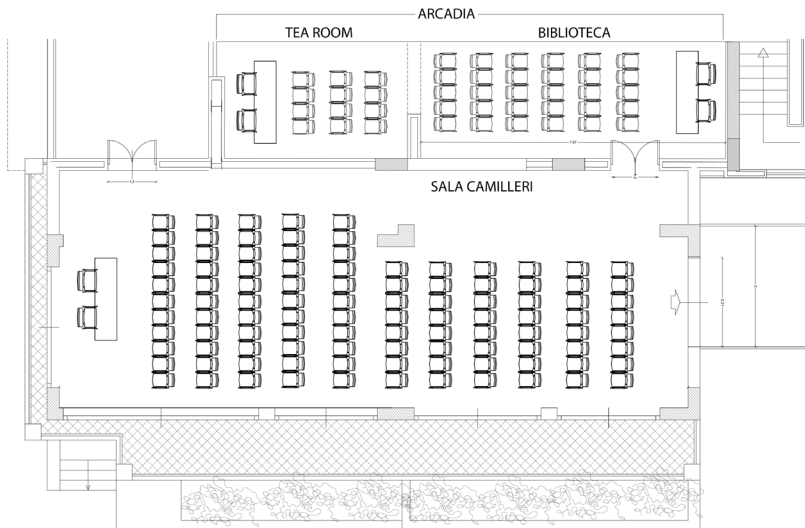

Four meeting rooms that can accommodate up to a total of 66 people, equipped with video projector, mobile and fixed microphone, audio-video system.

The occupations of each meeting room can be reduced following the anti-COVID 19 restriction.

Places of interest near the Hotel

- Villa Comunale - 600 metres
- Naumachie - 900 metres
- Corvaja Palace - 1 km
- Corso Umberto boulevard - 1.1 km
- Greek Theater - 1.1 km
- Odeon of Taormina - 1.1 km
- Mazzarò - 1.2 km
- Cathedral of Taormina - 1.4 km
- Isola Bella - 1,5 km
- Casa Cuseni - 2 km
- Spisone beach - 4.7 km
- Giardini Naxos - 5 km
- Mazzeo and Villagonia beach - 6.2 km
- Letojanni - 6,4 km
- Alcantara Gorges - 19.7 km
- Sant'Alessio Siculo beaches - 25.3 km
- Savoca (ME) - 26,8 km
- Sant'Alessio Castle - (ME) - 26,9 km
- Forza D'Agrò (ME) - 30,9 km
- Catania - 53,3 km
- Mount Etna (CT) - 55 km



Where we are

Our hotel is quite close to the centre of Taormina, 2 km from the beach.

How to get here

BY CAR: From **Messina**. Take the A20/E90 highway from Viale Boccetta. Drive on the A18/E45 up to Taormina. Take the Taormina exit. Once in Taormina, follow Via Nazionale/SS114 towards Via Luigi Pirandello/SP10. From **Palermo**. Take the E90 road from Via del Celso. Drive on the A20 up to Taormina. Take the Taormina exit. Once in Taormina, follow Via Nazionale/SS114 heading towards Via Luigi Pirandello/SP10

BY PLANE: From **Catania** ("Fontanarossa" airport) (68 km drive). Take the E45 road after leaving the SP701 road. Take the Taormina exit. Once in Taormina, follow Via Nazionale/SS114 towards Via Luigi Pirandello/SP10. From the **Palermo** Airport "Falcone e Borsellino" (302 km drive). Drive on the E90, A20 and A18/E45 up to Taormina. Take the Taormina exit. Once in Taormina, follow Via Nazionale/SS114 towards Via Luigi Pirandello/SP10.