

Vorpa TV

Fixing set for wall toilets and built-in toilets

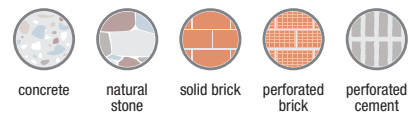

products group



* **TVN - TVN INOX A2**
nylon bushing
steel nut
wall plug VN
WALL TOILETS

Suitable for

- concrete
- natural stone
- solid brick
- perforated brick
- perforated cement

To fix

- wash basins
- built-in toilets
- urinal



* **TVM - TVM INOX A2**
nylon bushing
steel nut
wall plug VH
WALL TOILETS

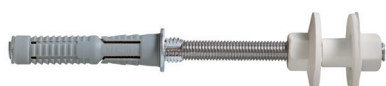

* **TVML - TVML INOX A2**
double flanged threaded nylon nuts
wall plug VH
BUILT-IN TOILETS



installation sequence

Clean the hole before the installation

On hollow brick

TVM - TVN

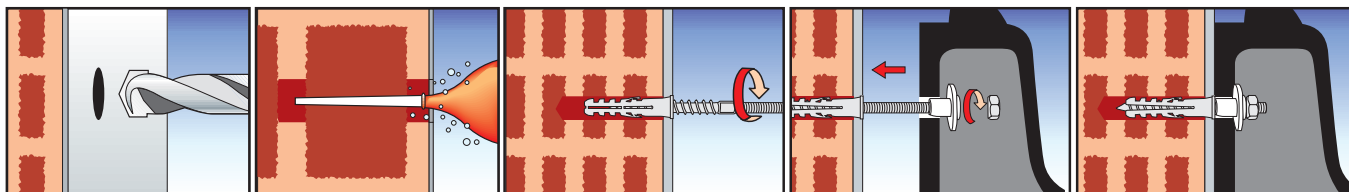

On solid brick

TVML

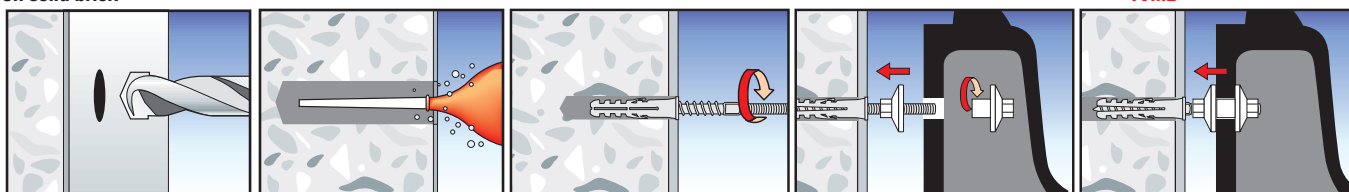

Examples of applications



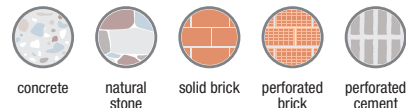

product code and technical data



* TVN - TVN INOX A2
nylon bushing - steel nut - wall plug VN



WALL TOILETS

Code	Description	L _t mm	d _o mm	h ₁ mm	L _p mm	Ø _p mm	T _{fix} mm
205	TVN 8/90	60	10	75	90	M8	25
206	TVN 10/120	60	12	75	120	M10	45
207	TVN 10/140	60	12	75	140	M10	65
* 1206	TVN 10/120 INOX A2	60	12	75	120	M10	45

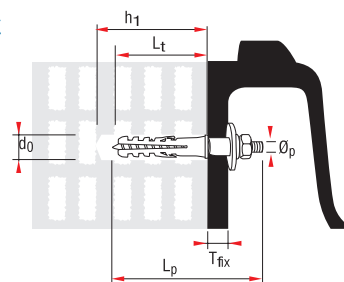

d_o = Hole diameter
h₁ = Min. hole depth
L_t = Plug length
L_p = Hook length
Ø_p = Hook diameter
T_{fix} = Fixture thickness

TVN - TVN INOX A2

Substrate materials	TVN 8/90 Ø10	TVN 10/120 Ø12	TVN 10/140 Ø12
Recommended values in daN			
Concrete C20/25	60	105	100
Double brick UNI with plaster	50	80	70

1 daN ≈ 1 kg



* TVM - TVM INOX A2
nylon bushing - steel nut - wall plug VH



WALL TOILETS

Code	Description	L _t mm	d _o mm	h ₁ mm	L _p mm	Ø _p mm	T _{fix} mm
231	TVM 10/145	70	14	85	145	M10	45
* 2231	TVM 10/145 INOX A2	70	14	85	145	M10	45

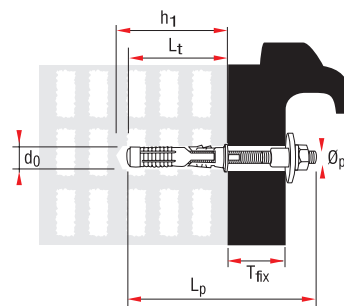

* TVML - TVML INOX A2
double flanged threaded nylon nuts - wall plug VH



BUILT-IN TOILETS

Code	Description	L _t mm	d _o mm	h ₁ mm	L _p mm	T _{fix} mm
232	TVML 10/180	70	14	85	180	85
* 2232	TVML 10/180 INOX A2	70	14	85	180	85

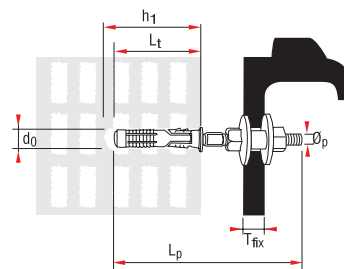

- always check load bearing capacity values in the table
- respect the installation data
- clean the hole before the installation

WALL TOILETS

BUILT-IN TOILETS

TVM - TVM INOX A2

TVML - TVML INOX A2

Substrate materials	TVM 10/145 Ø14	TVML 10/80 Ø14
Recommended values in daN		
Concrete C20/25	120	80
Double brick UNI with plaster	90	40

1 daN ≈ 1 kg