

Vorpa CFZ

White or black plastic-coated steel pipe clamp

products group

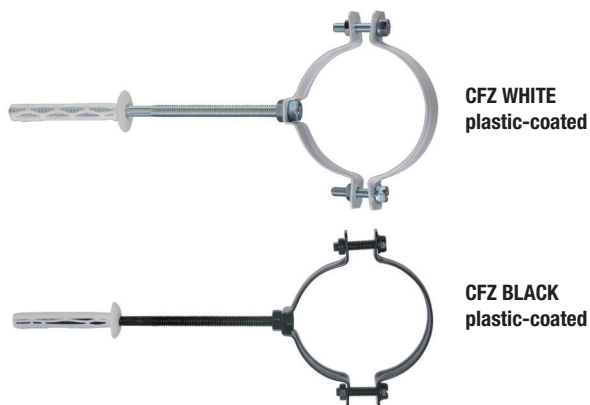

Suitable for

- concrete
- solid brick
- perforated brick
- aerated poroton
- perforated cement

To fix

- air ducts
- flues, smoking pipes

Plastic-coated steel clamp for smoking pipes

product code and technical data

CFZ WHITE plastic-coated

Code	Description	Nominal diameter	E x D mm	d ₀ x L _t mm	h ₁ mm	M x L _p mm	L _i mm	Side screws	
2406	CFZ white	60	60	24x2,2	10 x 80	85	M 8x200	150	M6x25
800	CFZ white	76-80	76-80	24x1,5	10 x 80	85	M 8x200	158	M6x25
794	CFZ white	100	100	24x1,5	10 x 80	85	M 8x200	170	M6x25
2485	CFZ white	110-120	110-120	24x1,5	10 x 80	85	M 8x200	175	M6x25
2486	CFZ white	125-130	125-130	24x1,5	10 x 80	85	M 8x200	182	M6x25
2488	CFZ white	140-150	140-150	24x1,5	10 x 80	85	M 8x200	190	M6x25
2487	CFZ white	160	160	24x1,5	10 x 80	85	M 8x200	200	M6x25

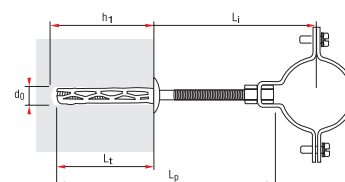

- d₀ = Hole diameter
- h₁ = Min. hole depth
- L_t = Anchor length
- L_p = Pin length
- ExD = Width x thickness
- ∅ = Pipe
- L_i = Axial spacing
- M = Thread

CFZ BLACK plastic-coated

800N	CFZ black	76-80	76-80	24x1,5	10 x 80	85	M 8x200	158	M6x25
794N	CFZ black	100	100	24x1,5	10 x 80	85	M 8x200	170	M6x25

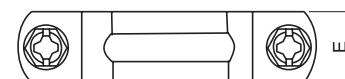
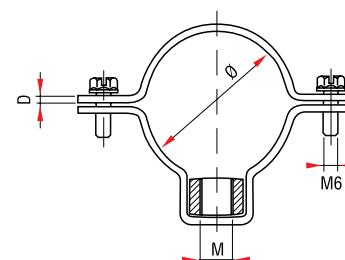

- always check load bearing capacity values in the table
- respect the installation data
- clean the hole before the installation

Examples of applications

