

Vorpa AV GR

Steel anchor for ropes and chains

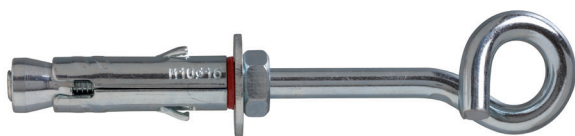

products group



- Suitable for**
- concrete
 - natural stone
 - solid brick

- To fix**
- ropes
 - chains

Tensioning ropes and chains

product code and technical data

Characteristics

- torque controlled expansion anchor AV GR composed of anti-rotation cold formed body, expansion conical nut, and steel hook for tensioning ropes and chains
- the eyebolt can be used several times thanks to the anchor spare part
- the anchor grants safe and easy applications
- various sizes of the hook available

Installation

- to be mounted aligned the wall

Suggestion for use

- always check load bearing capacity values in the table
- respect the installation data
- **clean the hole before the installation**

Code	Description	d_0 mm	L_t mm	h_1 mm	l mm	\varnothing_g mm	\varnothing_i mm	L_g mm	T_{inst} Nm
315	AV GR M10 Ø16/45-135	16	65	75	45	9	15	135	30
318	AV GR M10 Ø16/75-162	16	65	75	75	9	15	162	30
316	AV GR M10 Ø16/125-212	16	65	75	125	9	15	212	30

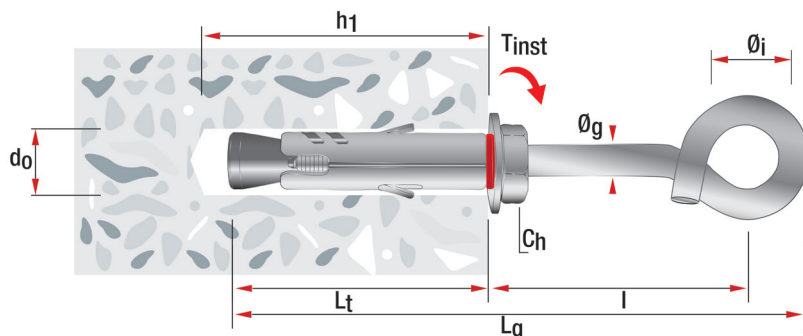

- d_0 = Hole diameter
- L_t = Anchor length
- h_1 = Min. hole depth
- l = Axial spacing
- \varnothing_g = Stem of the hook
- \varnothing_i = Internal eyebolt diameter
- L_g = Total length of the hook
- t_{fix} = Fixture thickness

installation sequence

1) installation procedure

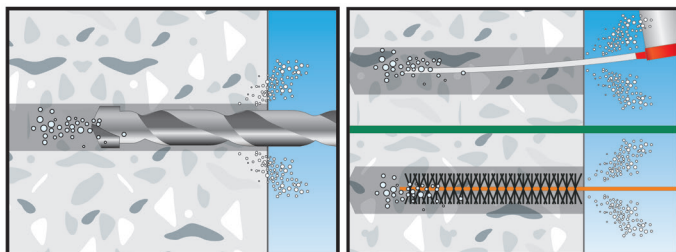

2) to re-use the eyebolt

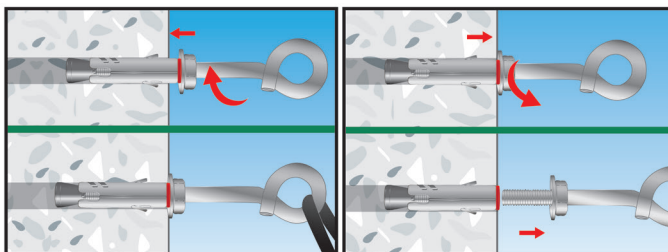

AV GR

Pull-out values in daN for applications on concrete C20/25

1 daN = 1 kg

Pull-out and shear

150*

* bending moment

ATTENTION: An appropriate safety factor ≥ 5 should be applied on these values

- As for applications on natural stones and solid bricks it is not possible to show specific loading values because of the various materials properties
- It is suggested to always make pull out tests before using the anchors