

ARIANNA VASO A5N01.BI

CE EN 997:2015

GLOBO



Scarico ottimizzato a 4/2,6 litri
Drain 4/2,6 lt

Cod. **A5N01.BI**

Vaso a terra 48.37 h41 cm. Scarico 4 / 2,6 Lt. Installazione distanziata da parete.

Completo di fissaggi. Peso 22 Kg

Floor mounted Wc 48.37 h41 cm. Drain 4 / 2,6 Lt. Wall spaced installation.

Fixing kit included. Weight 22 Kg

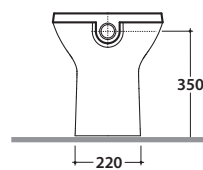
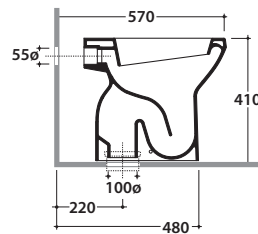
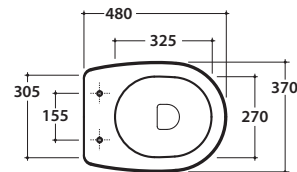

Trattamento antibatterico per sedili in
versione bianco lucido
Antibacterial treatment on toilet seats
in shiny white

Cod. **A5N19BI**

Coprivaso in duroplast con chiusura tradizionale. Peso 3 Kg

Duroplast seat-cover with traditional closing system. Weight 3 Kg

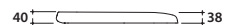
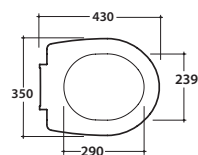
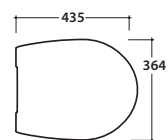

Cod. **VA132**

Riduttore flusso di scarico.

Flow reductor.